

# Series 20 / High Temp Stainless Steel Caster/Epoxy Wheel

## T20P3X3HNDDF

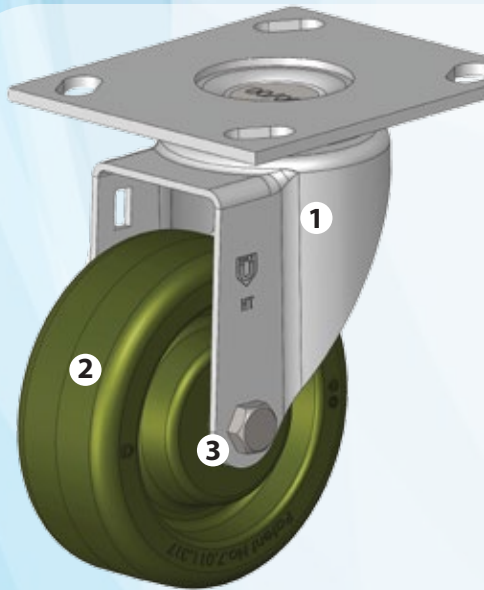

The P&H Series 20 products include casters and wheels that are designed to stand up to the challenges of harsh and demanding operating environments.

These casters feature our 304 stainless steel yokes. This premium grade of steel does not develop metal degradation and pitting when exposed to harsh chemicals, wet environments and high temperature applications that can occur with other types of steel.

These casters are highly durable, and provide superior floor protection.

## WHEEL

Diameter	4"
Tread Width	1 1/2"
Hub Width	1 3/4"
Bearing	Quad X Precision
Load Capacity	500 lbs.
Weight	1 lb.
Hardness (durometer)	A70
Bore	5/16"
Temperature Range	500° F Continuous 550° F Intermittent

## APPLICATIONS

- Autoclaves
- Smokehouses
- Laboratories
- Aerospace
- Bakeries
- Food service
- Food processing
- High temperature environments

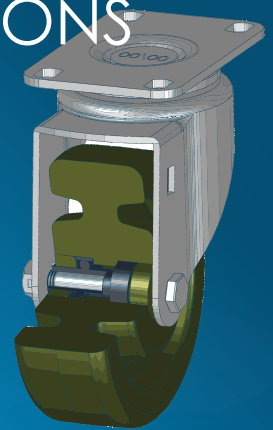

Wheels shown for this caster are our PolyU® High Temperature impact resistant epoxy resin, which we manufacture in several sizes to fit your specific application.

*This document contains a general description of available product options. Specific solutions will be based on a customer's unique requirements.*

T20P3X3HNDDF

- 1 - Certified 304 stainless steel yoke
- 2 - Epoxy Resin high temperature wheel
- 3 - Patented Quad X Precision Bearing

## FEATURES

### Wheel

- Patented, dual large precision bearing
- High temperature impact resistant epoxy resin
- Excellent for wet locations

### Yoke

- Non-rusting, heat resistant
- High temperature grease in swivel raceways
- Long lasting, NSF approved
- Ideal for washdown applications
- Available in zinc and stainless steel

NSF



W12043NG

## OPTIONS

Part No.	Diameter	Tread Width	Bearing	Bore	Color/Material
W12043NG	4"	1.5"	Quad X	5/16"	Green on Aluminum
W22043NUQ	4"	1.5"	Precision	3/8"	Green on Aluminum
W22043N2B	4"	1.5"	Stainless Steel Precision	5/16"	Green on Aluminum
W22043N2Q	4"	1.5"	Stainless Steel Precision	3/8"	Green on Aluminum
W12043NH	4"	1.5"	Plain	3/8"	Green Epoxy Resin



800 354 8622  
orders@phcasters.com  
www.phcasters.com